

ASSEMBLY INSTRUCTIONS

THIS UNIT OFFERS TWO DIFFERENT ASSEMBLY OPTIONS DEPENDING ON THE DESIRED LOOK.

NOTE: IMAGES ARE FOR ILLUSTRATION PURPOSES ONLY.

OPTION (1)

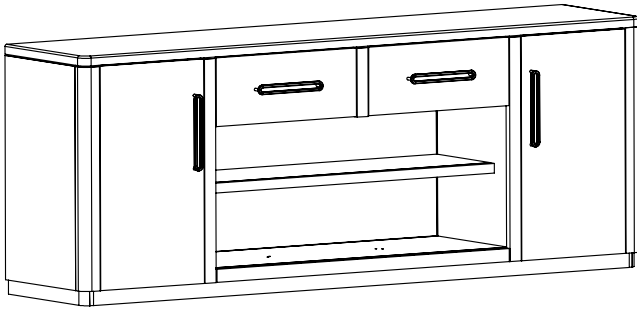

OPTION (2)

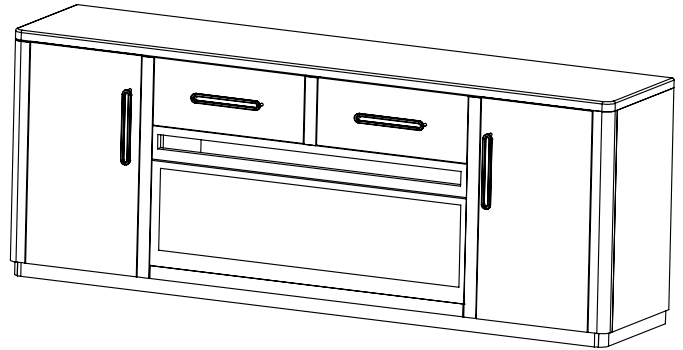

STEP 1: REMOVING REAR BRACKETS.

LOCATE THE MOUNTING BRACKETS ON THE BACK OF THE FURNITURE.
REMOVE THE SCREWS TO DETACH THEM, AS SHOWN IN DETAIL (A).

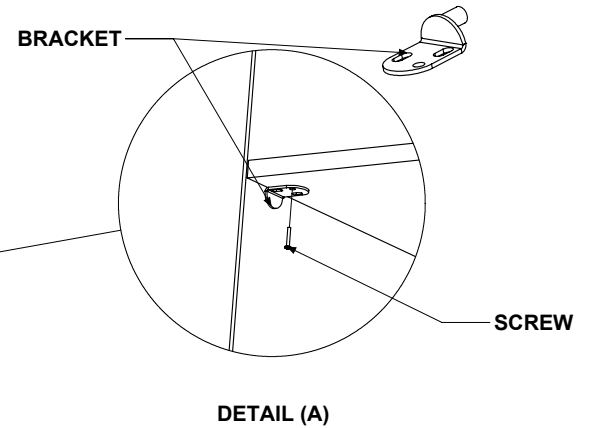
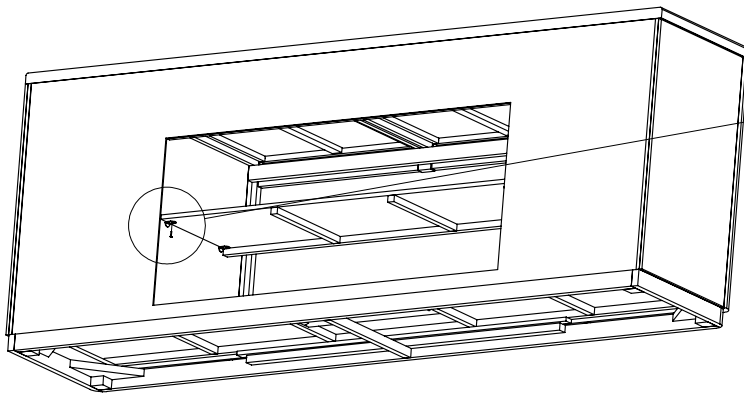

STEP 2: INSERTING THE FIREPLACE.

ONCE THE BRACKETS ARE REMOVED, TAKE OUT THE SHELF AS SHOWN
IN DETAIL B. NEXT, INSERT THE FIREPLACE (IFD-EFP42) FROM THE BACK
OF THE UNIT. SLIDE IT FORWARD UNTIL IT RESTS AGAINST THE INTERNAL
POSTS, AS SHOWN IN DETAIL C.

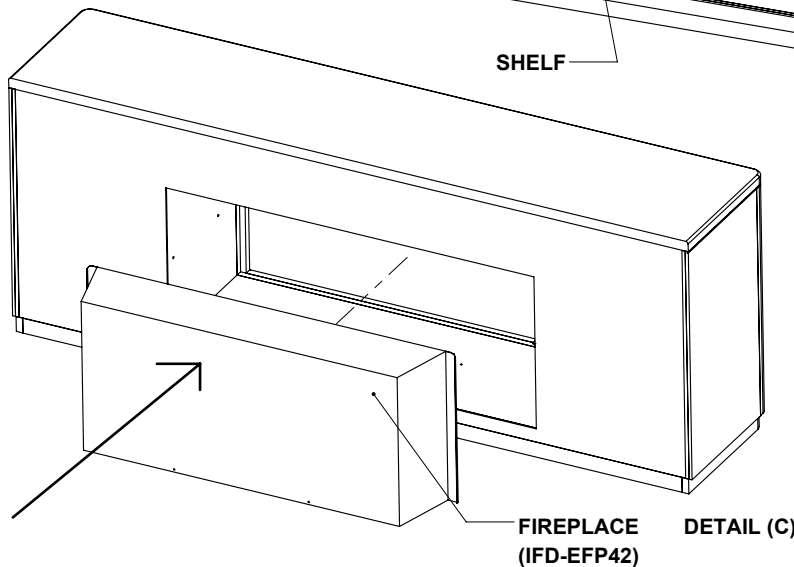
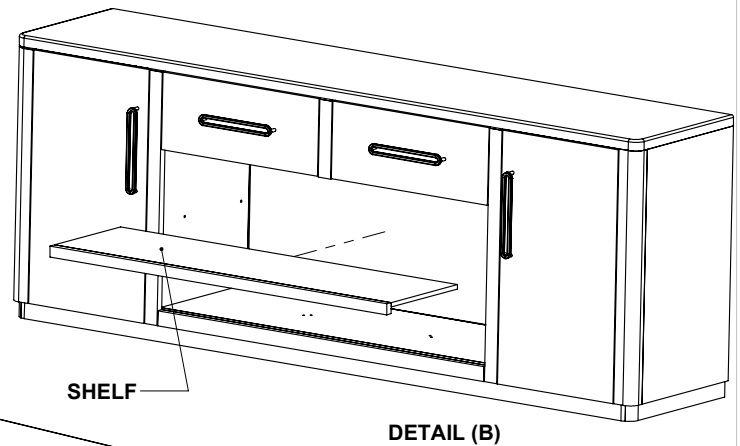

ASSEMBLY INSTRUCTIONS

STEP 3: REMOVING REAR SCREWS.

ONCE POSITIONED, LOCATE THE TWO SCREWS ATTACHED TO THE BACK OF THE FIREPLACE. REMOVE THEM AS SHOWN IN DETAIL (D).

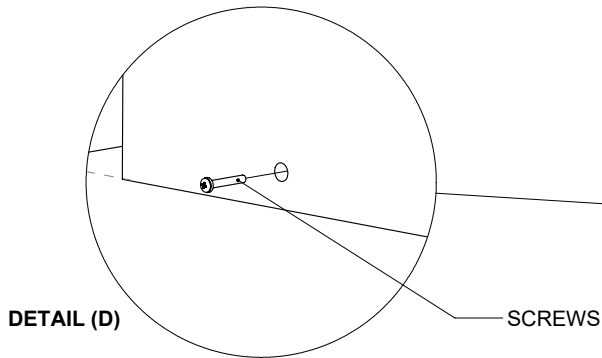

STEP 4: INSTALLING BRACKETS.

LOCATE THE METAL BRACKETS INSIDE THE FIREPLACE BOX. ALIGN THE BRACKET WITH THE HOLES WHERE THE SCREWS WERE PREVIOUSLY REMOVED, AS SHOWN IN DETAIL (E). REPEAT THIS PROCESS ON THE OTHER SIDE.

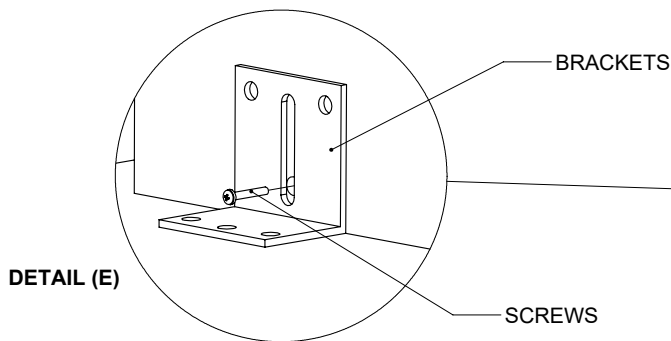

STEP 5: SECURING TO THE BASE.

ALMOST DONE! SECURE THE BRACKETS TO THE BOTTOM PANEL USING SCREWS, AS SHOWN IN DETAIL (F). NOTE: THIS STEP IS OPTIONAL IF YOU DO NOT WISH TO PERMANENTLY SECURE THE FIREPLACE.



STEP 6: FINAL PLACEMENT

FINALLY, PLACE THE FURNITURE IN YOUR DESIRED LOCATION. REMEMBER THAT YOU CAN ALSO REINSTALL THE SHELF.

