

INSTRUCTIONS (A)

1.- TO START ASSEMBLING THE WALL UNIT YOU MUST PLACE PIERS AND STAND FRONT THE WALL WHERE YOU WANT PLACE IT, TAKE CARE OF LEAVE A LITTLE SPACE BETWEEN THE WALL TO WORK BEHIND THEM.

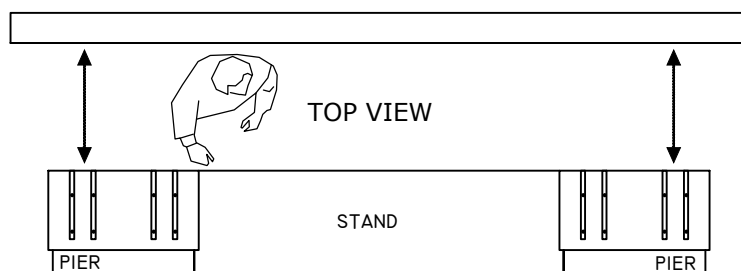

2.- TO DEFINE THE RIGHT DISTANCE OF BOTH PIERS, INTRODUCE THE STAND BETWEEN THEM. ALIGN THE FRONT AND BACKREST.

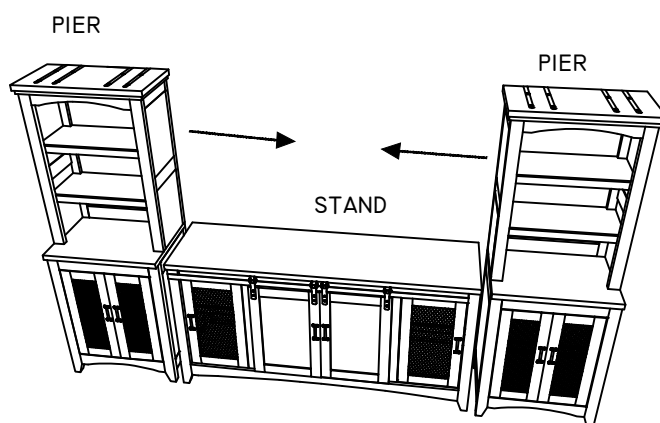

3.- WITH LITTLE HELP PLACE THE BRIDGE ON THE PIERS ALIGNING THE HOLES WITH THE TOP BRIDGE AND PIERS TO SCREW THEM AS SHOW IN FIG. 1

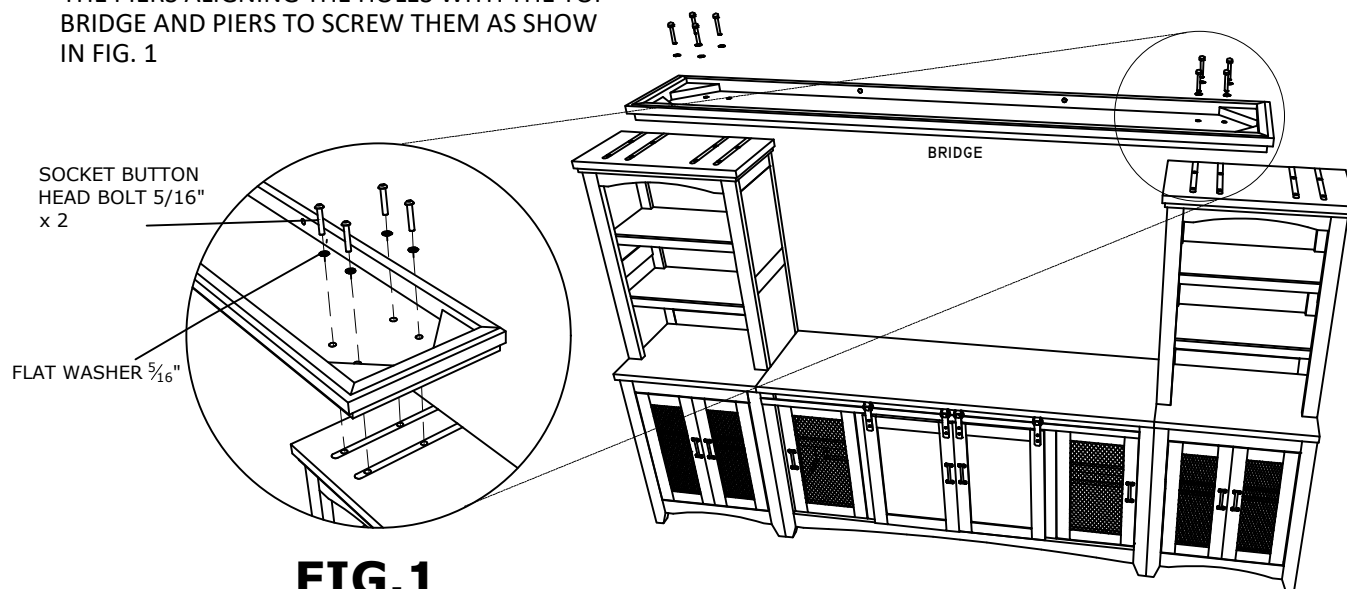

INSTRUCTIONS (B)

4.- HOOK UP THE IRON SUPORT ON THE BRIDGE TOP ALIGNING THE HOLES IN THE TOP AND SCREW AS SHOW IN FIG.2

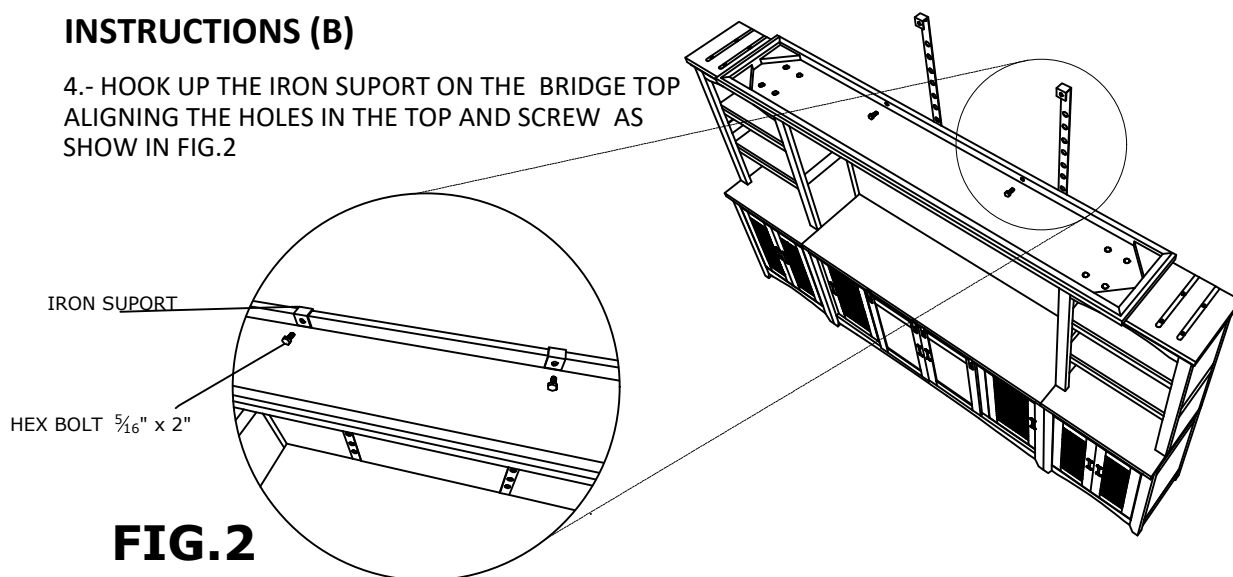

5.- PIN UP THE BACKREST SLATS ASK SOME HELP OF SOMEONE TO ALIGN THE HOLES OF THE SLATS WITH THE IRON SUPORT AND SCREW AS SHOW IN FIG. 3.

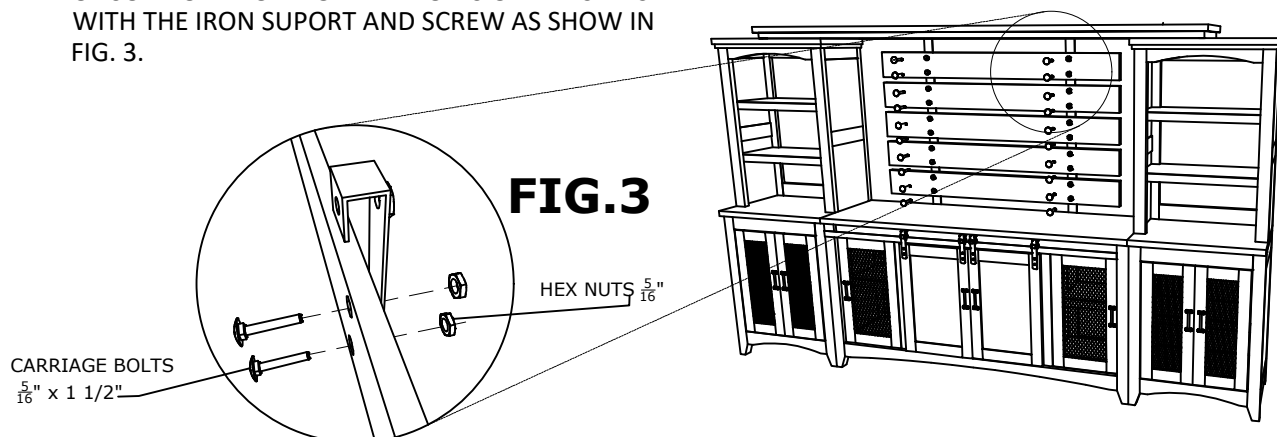

5.- WITH HELP OF SOMEONE ELSE MOVE TO THE WALL THE PIERS AND BRIDGE PREVIOUSLY ASSAMLED

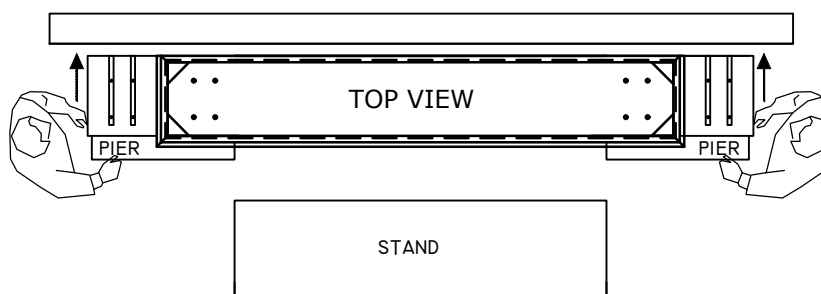

INTERNATIONAL
FURNITURE DIRECT, LLC

ASSEMBLY INSTRUCTIONS

360,9232 WALLUNIT

UI-BRD-E001

INSTRUCTIONS (C)

6.-TO FINISH THE WALL UNIT PLACE AGAIN THE STAND BETWEEN THE PIERS.

7.- ALIGN THE HOLES INSIDE THE LATERAL DOORS OF THE STAND WITH THE IRON SUPORT ONES AND SCREW AS SHOW IN FIG.4

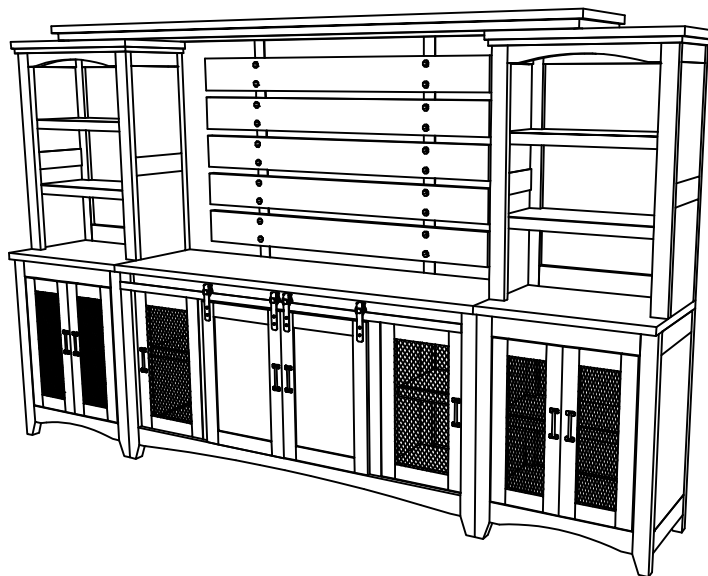
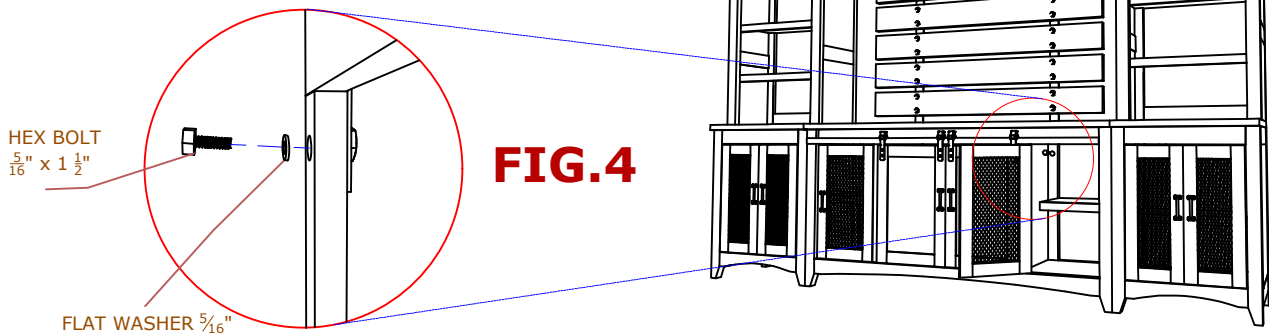

DESCRIPTION	#PZ
SOCKET BUTTON HEAD BOLT 5/16" x 2"	8
FLAT WASHER 5/16"	10
HEX BOLT 5/16" x 2"	2
CARRIAGE BOLTS 5/16" x 1 1/2"	20
HEX NUTS 5/16"	20
HEX BOLT 5/16" x 1 1/2"	2

THE PICTURE ARE NOT REAL ONLY IS INFORMATIVE



INTERNATIONAL
FURNITURE DIRECT, LLC

ASSEMBLY INSTRUCTIONS

3/3

360,9232 WALLUNIT

UI-BRD-E001
BY:

ITEM	DESCRIPTION	#PZ
1TOR004	Tornillo Allen bola $\frac{5}{16}$ " x 2 "	8
1RON003	Rondana Plana $\frac{5}{16}$ " X 1" Galv.	10
1TOR024	Tornillo Hexagonal $\frac{5}{16}$ " x 2" R/C Negro	2
1TOR079	Tornillo Cabeza Coche $\frac{5}{16}$ " x 1 $\frac{1}{2}$ "	20
1TUER033	Tuerca Standar $\frac{5}{16}$ "	20
1TOR022	Tornillo Hexagonal $\frac{5}{16}$ " x 1 $\frac{1}{2}$ " R/C Galv.	2

NOTA PARA 9232 WALLUNIT
TORNILLO CABEZA COCHE $\frac{5}{16}$ x 1 $\frac{1}{2}$
PINTAR CAFE
360,9232 WALLUNIT